



## Jetter Hose with Tri-Jet Nozzle

<b>Standard Models</b>	34641
	34642
<b>TUFF CAT Models</b>	34643
	34644

### FEATURES

- Extremely flexible 30' or 50', 1/8" hose with wear resistant smooth finish.
- Tight 1/2" bend radius for maximum flexibility with 1/3 the weight of wire braid hose.
- Multi-directional cleaning while self-propelling through pipes.

**SELECTION:** Select the Jetter Hose and Nozzle to match the system flow and pressure ratings shown in the specifications.

**INSTALLATION:** The Jetter Hose and Nozzle should be installed on the high pressure side of the pump. The TUFF CAT models 34643 (30 ft.) or 34644 (50 ft.) connect directly to the 34124.220 gun and lance assembly.

**OPERATION:** The Tri-Jet Nozzle is activated as soon as the high pressure system is turned on and the high pressure gun trigger is squeezed. Flow goes through the high pressure hose to the specially

### SPECIFICATIONS

	U.S. Measure	Metric Measure
Maximum Flow .....	3.0 GPM	(11 L/M)
Maximum Pressure .....	2000 PSI	(140 BAR)
Inlet Connection		
Standard.....	1/4" NPTM	(1/4" NPTM)
TUFF CAT.....	1/4" Q.C.	(1/4" Q.C.)
Nozzle Connection.....	1/8" NPTM	(1/8" NPTM)
Maximum Temperature .....	180°F	(82°C)
Hose Rating.....	2500 PSI	(175 BAR)
Hose Length		
34641, 34643 .....	30 ft.	(9.1 M)
34642, 34644 .....	50 ft.	(15.2 M)
Weight		
30 ft.....	16.0 oz.	(0.49 kg)
50 ft.....	26.5 oz.	(0.81 kg)

designed Tri-Jet Nozzle delivering a three-directional blasting spray.

The Tri-Jet Nozzle blasts pipe walls clean while it propels the nozzle assembly down the pipe. The Jetter Hose and Nozzle assembly works best with a pulsation feature installed on the pump or cleaning system. Consult the factory for this modification.

**MAINTENANCE:** For optimum performance, periodically check and clean the nozzle and replace if worn. The hose may wear with use, especially if dragged regularly over rough surfaces. Check hose condition periodically for safety.

*“Customer confidence is our greatest asset”*

## EXPLODED VIEW

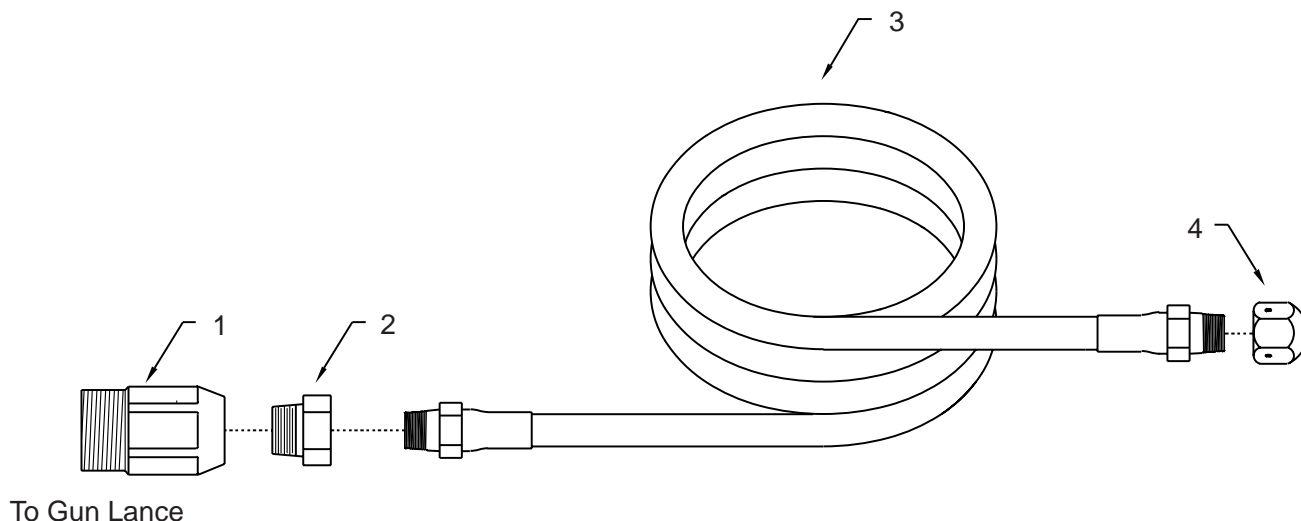

### PARTS LIST

ITEM	P/N	MATL	DESCRIPTION	MODEL	QTY.
1	34023	BB	Adapter, Hex (1/4" NPTM)	34643, 34644	1
2	34633	BB	Bushing, Reducing (1/4" NPTM x 1/8" NPTF)	34643, 34644	1
3	34638		Hose (1/8" NPTM x 30 ft.)	34641, 34643	1
	34639		Hose (1/8" NPTM x 50 ft.)	34642, 34644	1
4	36634	S	Nozzle, Tri-Jet, 2.5 GPM, 2000 PSI (1/8" NPTF)	All Models	1

Material Codes (Not Part of Part No.): BB=Brass S=304 Stainless Steel

### TROUBLESHOOTING

Pressure spike	<ul style="list-style-type: none"> <li>• Clogged nozzle. Clean or replace nozzle.</li> </ul>
Hose won't advance down pipe	<ul style="list-style-type: none"> <li>• Worn or clogged nozzle. Clean or replace nozzle.</li> </ul>
Pressure drops	<ul style="list-style-type: none"> <li>• Worn nozzle. Clean or replace nozzle.</li> <li>• Leaking hose or fittings. Replace hose.</li> </ul>

### WARRANTY

#### 90 Day Warranty

Refer to complete Cat Pump Warranty for further information.

Products described hereon are covered by one or more of the following U.S. patents 3558244, 3652188, 3809508, 3920356, 3930756 and 5035580

Nov 1998 11836

#### World Headquarters

##### CAT PUMPS

1681 - 94th Lane N.E. Minneapolis, MN 55449-4324

Phone (612) 780-5440 — FAX (612) 780-2958

e-mail: sales@catpumps.com

www.catpumps.com

#### International Inquiries

FAX (612) 785-4443

e-mail: intlsales@catpumps.com



*The Pump with "Nine Lives"*

#### CAT PUMPS (U.K.) LTD.

1 Fleet Business Park, Sandy Lane, Church Crookham, Fleet

Hampshire GU13 0BF, England

Phone Fleet 44 1252-622031 — Fax 44 1252-626655

#### N.V. CAT PUMPS INTERNATIONAL S.A.

Heiveldkens 6A, 2550 Kontich, Belgium

Phone 32-3-450.71.50 — Fax 32-3-450.71.51

e-mail: cpi@catpumps.be

#### CAT PUMPS DEUTSCHLAND GmbH

Buchwiese 2, D-65510 Idstein, Germany

Phone 49 6126-93030 — Fax 49 6126-930333

e-mail: catpumps@t-online.de