



Power-Chem Nozzle

High Pressure Injector

Long Distance Sprayer

Standard Models

7314, 7315, 7316

Stainless Steel Models

7324, 7325, 7326

FEATURES

- Unique chemical-siphoning system for introducing cleaning chemicals into the high pressure spray at the nozzle.
- Nozzle barrel propels a concentrated spray pattern up to 25-35 feet with significant impact.
- Stainless Steel construction provides high strength and chemical resistance.
- Interchangeable orifices (internal nozzle) allows for wide range of flows and pressure combinations.
- Adjustment knob at the nozzle body allows for convenient chemical metering.
- 30 feet of clear transfer tube allows cleaning flexibility and system monitoring.
- Check valve prevents the reversal of solution back to the chemical container.
- Weighted strainer filters unwanted debris from entering the chemical stream.

SELECTION: Select the model with the flow and pressure rating for your system per the NOZZLE SELECTION CHART. The stainless steel construction makes this nozzle suitable for various soaps, sanitizers, fungicides and chemical cleaning solutions.

SPECIFICATIONS

	U.S. Measure	Metric Measure
Flow Range	2.0 to 6.7 GPM	(7.6 to 26 L/M)
Maximum Pressure	5000 PSI	(345 BAR)
Max. Chemical Draw	1/2 GPM	(1.9 L/M)
Max. Horizontal Spray Distance	35 ft.	(10.6 M)
Maximum Temperature	210°F	(98°C)
Inlet Ports (QD Nipple)	1/4"	(1/4" QD)
Chemical Tube Length	30 ft.	(9.1 M)
Weight	1.54 lbs.	(0.7 kg)
Dimensions (Body Only)	2.5"x.75"	(63.5x19 mm)
(w/QD)	3.75"x.75"	(95x19 mm)

INSTALLATION: Snap securely onto a properly rated, 1/4" QD socket installed at the lance end. With this Power-Chem Nozzle no chemicals will go through the pump, lance or hose.

“Customer confidence is our greatest asset”

OPERATION: Place clear hose with filter into chemical supply and start system to draw chemical. The adjustable barb on the bottom of the injector body allows fine tuning of the chemical draw up to approximately 1/2 GPM. To maintain this precise adjustment, a shut off valve can be installed in the chemical line to periodically shut off chemical flow and return to the exact setting. **Maximum spraying distance is achieved with flows of 4 GPM or more and remains fairly consistent between 1000 and 5000 PSI.** For continuous maximum chemical draw, use the fixed barb. See NOZZLE SELECTION CHART.

MAINTENANCE: Like all nozzles, the internal nozzle will wear with use. To change the nozzle remove the threaded QD plug at the bottom of the body.

Periodically inspect the chemical filter and clean as needed to avoid restricted flow through the Power-Chem Nozzle. Replace if too contaminated.

EXPLODED VIEW

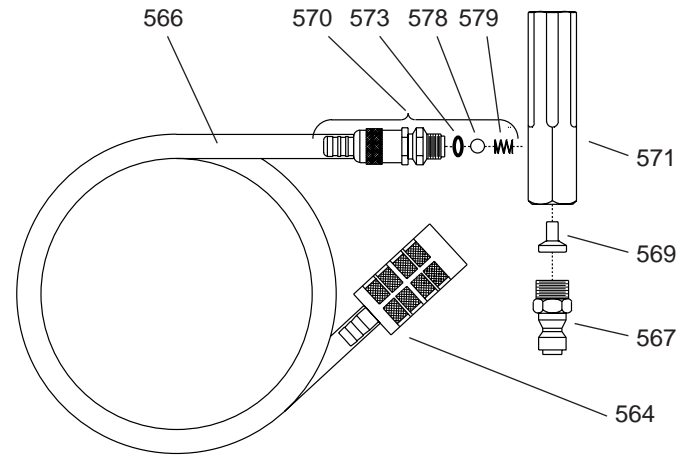

PARTS LIST

ITEM	PN	MATL	DESCRIPTION	MODEL USED	QTY
564	32673	PVC	Filter, w/Check Valve	All	1
566	34313	PVC	Tubing, 30 ft., Clear	All	1
567	34367	STL	Plug, QD (1/4" NPT)	7314, 15, 16	1
	34487	S	Plug, QD (1/4" NPT)	7324, 25, 26	1
569	34484	SS	Orifice #4.0	7314, 7324	1
	34485	SS	Orifice #5.0	7315, 7325	1
	34486	SS	Orifice #6.0	7316, 7326	1
570	34214	BBNP	Barb, w/Check Valve	7314, 15, 16	1
			(Incls: 573, 578, 579)		
	34216	S	Barb, Fixed	7324, 25, 26	1
571	34483	S	Body, Power-Chem	All	1
573	—	NBR	O-Ring	All	1
578	—	CC	Ball	All	1
579	—	S	Spring	All	1

Italics are optional items

MATERIAL CODES (Not Part of Part Number): BBNP=Brass/Nickel Plated
CC=Ceramic NBR=Medium Nitrile (Buna-N) PVC=PVC S=304SS
SS=316SS STL=Steel

CAUTION

Do not install nozzle onto exterior of the threaded port on body. The orifice is already installed inside the body.

NOZZLE SELECTION CHART

Nozzle Size	Estimated Horizontal Spray Distance Feet	GPM@Specified Pressure Selections					Standard Barb Max. Chemical Draw GPM	Fixed Barb Max. Chemical Draw GPM
		PRESSURE						
		PSI 1000 BAR (70)	PSI 2000 BAR (140)	PSI 3000 BAR (210)	PSI 4000 BAR (275)	PSI 5000 BAR (345)		
4.0	25	2.0	2.8	3.5	4.0	4.5	.25	.35
5.0	30	2.5	3.8	4.4	5.0	5.6	.25	.35
6.0	35	3.0	4.2	5.2	6.0	6.7	.25	.35

TROUBLESHOOTING

No chemical draw	<ul style="list-style-type: none"> • Replace adjustable barb with straight barb. • Increase diameter or remove kink in tube. • Clean inlet filter. • Change nozzle.
Spray distant too short	<ul style="list-style-type: none"> • Increase flow. • Replace worn nozzle.

WARRANTY

90 Day Warranty

Refer to complete Cat Pump Warranty for further information.

Products described hereon are covered by one or more of the following U.S. patents 3558244, 3652188, 3809508, 3920356, 3930756 and 5035580

Oct 1998 10832

World Headquarters

CAT PUMPS

1681 - 94th Lane N.E. Minneapolis, MN 55449-4324

Phone (612) 780-5440 — FAX (612) 780-2958

e-mail: sales@catpumps.com

www.catpumps.com

International Inquiries

FAX (612) 785-4443

e-mail: intlsales@catpumps.com



The Pump with "Nine Lives"

CAT PUMPS (U.K.) LTD.

1 Fleet Business Park, Sandy Lane, Church Crookham, Fleet

Hampshire GU13 0BF, England

Phone Fleet 44 1252-622031 — Fax 44 1252-626655

N.V. CAT PUMPS INTERNATIONAL S.A.

Heiveldkens 6A, 2550 Kontich, Belgium

Phone 32-3-450.71.50 — Fax 32-3-450.71.51

e-mail: cpi@catpumps.be

CAT PUMPS DEUTSCHLAND GmbH

Buchwiese 2, D-65510 Idstein, Germany

Phone 49 6126-93030 — Fax 49 6126-930333

e-mail: catpumps@t-online.de