

4 Frame Piston Pump Models

333 430

FEATURES

Superior Design

- Triplex UniFlo design provides continuous forward fluid flow for smooth operation.
- Wetted cups and floating pistons are lubricated and cooled by pumped fluid for long cup life.
- Mechanically actuated inlet valves give strong lift and easy prime.
- 304 stainless steel discharge valves for wear resistance.
- Oil bath crankcase assures optimum lubrication.
- 100% wetted seal design allows pumped fluid to cool and lubricate for longer life.

Quality Materials

- Cylinder and sleeve wear surfaces are hard chrome plated 304 stainless steel for maximum durability and abrasion resistance.
- Chrome plated, brass manifolds and optional stainless steel manifolds are strong and corrosion resistant.
- Heavy duty connecting rods are made of high quality Zamak offering superior bearing quality strength.
- Chrome-moly crankshaft gives unmatched strength and surface hardness.
- Oversized crankshaft bearings with greater loading capacity mean longer bearing life.

Easy Maintenance

- Stepped stainless steel piston rod with chrome-plated, stainless steel sleeve allows easy replacement from front of pump.
- All wet-end wear parts are easily serviced without entering crankcase, requiring less time and effort.
- Wear parts are available in convenient kits.
- Routine lubrication checks are the only maintenance required on this precision built pump.

$$\frac{\text{DETERMINING THE PUMP R.P.M.}}{\text{Rated G.P.M.}} = \frac{\text{“Desired” G.P.M.}}{\text{Rated R.P.M.}}$$

$$\frac{\text{DETERMINING THE REQUIRED H.P.}}{\text{GPM} \times \text{PSI}} = \frac{\text{Electric Brake H. P. Required}}{1460}$$

$$\frac{\text{DETERMINING MOTOR PULLEY SIZE}}{\text{Motor Pulley O.D.}} = \frac{\text{Pump Pulley O.D.}}{\text{Motor R.P.M.}}$$

Note: Consult engine manufacturer when using gas or diesel engine. Refer to pump Service Manual for important Inlet Condition Check-List, Start-up Procedure, Tech Bulletins and Pump Maintenance information.

SPECIFICATIONS

MODEL 333

	U.S. Measure	Metric Measure
Volume	4.0 GPM	(15 L/M)
Discharge Pressure	100 to 1200 PSI	(7 to 85 BAR)
RPM	1070 RPM	(1070 RPM)
Bore	0.709"	(18 mm)

MODEL 430

Volume	5.0 GPM	(19 L/M)
Discharge Pressure	100 to 1000 PSI	(7 to 70 BAR)
RPM	1040 RPM	(1040 RPM)
Bore	0.787"	(20 mm)

COMMON SPECIFICATIONS

Stroke	0.768"	(19.5 mm)
Crankcase Capacity	21 oz.	(0.6 L)
Maximum Fluid Temperature	160°	(71°C)
Max. Inlet Pressure	-8.5 to +40 PSI	(-0.6 to +2.8 BAR)
Inlet Ports (1)	1/2" NPT	(1/2" NPT)
Injection Port (1)	1/4" NPT	(1/4" NPT)
Discharge Ports (2)	3/8" NPT	(3/8" NPT)
(1)	1/2" NPT	(1/2" NPT)
Pulley Mounting	Either Side	(Either Side)
Shaft Diameter	0.650"	(16.5 mm)
Weight	17.7 lbs.	(8.0 kg)
Dimensions	12.8" x 8.8" x 5.4"	(326 x 223 x 137mm)

HORSEPOWER REQUIREMENTS

MODEL	FLOW		PRESSURE			MOTOR PULLEY SIZE	
			PSI 800	PSI 1000	PSI 1200	Using 1725 RPM Motor & Std. 8" Pump Pulley O.D.	
	U.S. GPM	L/M	BAR 55	BAR 70	BAR 85	RPM	Pulley O.D.
333	4.0	15	2.2	2.8	3.3	1070	5.0
	3.0	11	1.6	2.1	2.5	803	3.8
	2.0	7.6	1.1	1.4	1.6	535	2.5
430	5.0	19	2.7	3.4	N/A	1040	5.1
	4.0	15	2.2	2.8	N/A	832	4.1
	3.0	11	1.6	2.1	N/A	624	3.1

“Customer confidence is our greatest asset”

PARTS LIST

ITEM	PART NUMBER		DESCRIPTION	QTY
	333	430		
2	30047	STL	Key (M5x5x24)	1
5	92519	STZP	Screw, Sems HHC (M6x16)	8
8	27950	AL	Cover, Bearing	2
10	26536	NBR	O-Ring, Bearing Cover - 70	2
11	24159	NBR	Seal, Oil	2
15	14487	STL	Bearing, Ball	2
20	24139	ZZ	Rod, Connecting	3
25	43163	FCM	Crankshaft, Dual End, Tapped (M8x1.25)	1
31	828710	828710	Protector, Oil Cap	1
32	43211		Cap, Oil Filler	1
33	14177	NBR	O-Ring, Oil Filler Cap -70	1
37	43987		Gauge, Oil Bubble	1
38	44428	NBR	Gasket, Flat, Oil Gauge - 80	1
40	92520	STZP	Screw, Sems HHC (M6x20)	4
48	25625	STCP	Plug, Drain (1/4" NPT)	1
49	23170	NBR	O-Ring, Drain Plug	1
50	43339	AL	Cover, Crankcase	1
51	43340	NBR	O-Ring, Crankcase Cover	1
53	43735	AL	Crankcase	1
55	14137	STCP	Stud (M8x41.4)	2
56	27712	POP	Pan, Oil (use with Blue-Dot Seals and Wick)	1
64	16948	S	Pin, Rist	3
65	27981	SZZ	Rod, Piston	3
69	20017	STZP	Washer, Oil Seal	3
70	25301	NBR	Seal, Oil, Crankcase - 80	3
71	26854	S	Washer, Oil Seal	3
75	25327	S	Slinger, Barrier	3
77	25392	NBR	O-Ring, Sleeve	6
	28771	FPM	O-Ring, Sleeve	6
	28772	PTFE	O-Ring, Sleeve	6
80	25299	SCP	Sleeve	3
	28460	S	Sleeve	3
100	27710	PVDF	Retainer, Seal	3
101	27711		Wick, Long Tab (use with Blue-Dot Seals and Oil Pan)	3
106	30315	NBR	Seal, Prrrrrrm-A-Lube	3
	30325	FPM	Seal, Prrrrrrm-A-Lube	3
	25153	NBR	Seal, Blue-Dot (use with Wick and Oil Pan)	3
109	22177	BBCP	Plug (1/4" NPT)	1
110	25128	BBCP	Manifold, Inlet	1
	25635	SS	Manifold, Inlet (331, 431)	1
118	22160	BBCP	Elbow, Street (1/2" NPT)	1
119	28339	S	Valve, Inlet	3
130	43784	S	Piston	3
131	43719	PTFE	Back-up-Ring, Bac-Cup	3
133	43717	FPM	Cup, Piston	3
133	43826	FPM	Assy, Bac-Cup (Incls: 130,131,133) 333 only	3
133	28955	NBR	Cup, Piston, Machined	3
133	29088	NBR	Cup, V-Hot	3
135	27983	S	Spacer, Piston	3
136	27002	S	Retainer, Piston	3
137	27006	S	Washer, Conical (M6)	3
138	27000	S	Nut, Slotted (M6)	3
139	14158	S	Cotterpin (M1.6x10)	3
143	23172	NBR	O-Ring, Cylinder - 70	6
	11377	FPM	O-Ring, Cylinder	6
	26961	PTFE	O-Ring, Cylinder	6
150	25660	SCP	Cylinder	3
	29013	S	Cylinder	3
153	21985	PTFE	Back-up-Ring, Cylinder	3
164	43434	S	Seat, Q.V.	3
	29487	S	Seat, F.V.	3
166	43723	S	Valve, Q.V.	3
	22842	S	Valve, F.V.	3
167	43360	S	Spring, Q.V.	3
	22031	S	Spring, F.V.	3
168	43442	S	Retainer, Spring, Q.V.	3
	22841	S	Retainer, Spring, F.V.	3
185	24459	BBCP	Manifold, Discharge	1
	25634	SS	Manifold, Discharge (331, 431)	1
	6400	BB	Manifold, Pulse Pump (335, 435)	1
	6300	SS	Pump, Pulse (335, 435)	1
186	15845	STZP	Lockwasher, Split (M8)	2
187	25337	BBCP	Bolt, Cylinder	2
188	43425	STZP	Washer, Shim (13MMODxM8x2)	2/4
189	22902	STZP	Washer, Shim (13MMODxM8x1)	2/4
190	13533	STZP	Washer, Shim (13MMODxM8x0.5)	2/4
191	43258	STZP	Washer, Shim (13MMODxM8x0.3)	2/4
192	26676	STZP	Washer, Retaining (M8)	2
194	101804	STZP	Nut, Hex Flange (M8)	2
196	22187	BBCP	Plug (3/8" NPT)	1
250	25130	STCP	Protector, Shaft	1
255	30243	STZP	Kit, Direct Mount (Incls: 12489,15845,81109,85631)	1
260	30611	STZP	Assy, Angle Rail (Incls: 28499,30900,30920,30910)	1
265	30652		Kit, Mounting (Incls: 30611,30048,30047,25130)	1
270	30244	STL	Assy, Pulley (Incls: 30048,30047)	1

EXPLODED VIEW

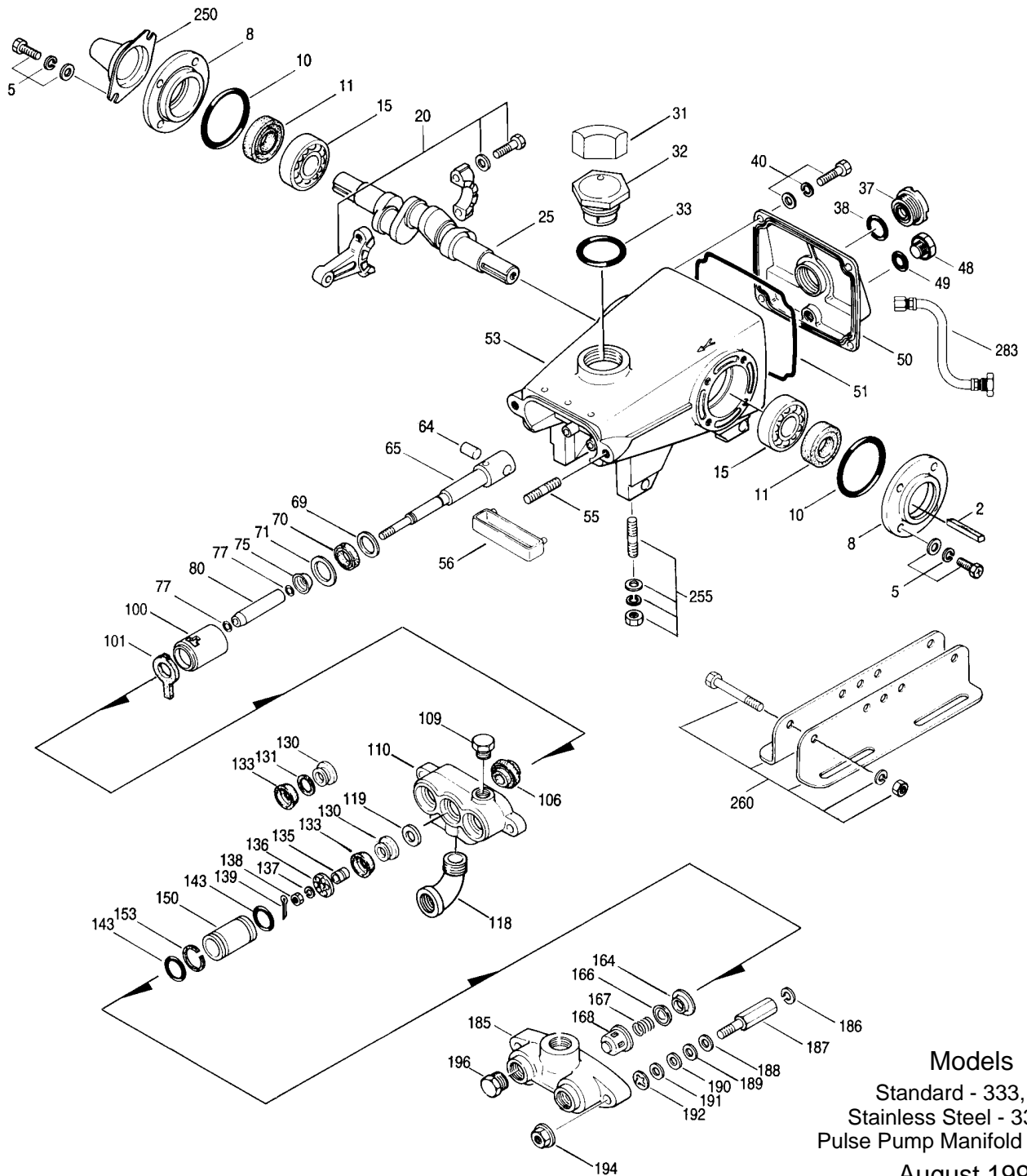

Models
 Standard - 333, 430
 Stainless Steel - 331, 431
 Pulse Pump Manifold - 335, 435
 August 1998

● 283	34334	34334	Kit, Oil Drain	1 ●
300	30239 NBR	—	Kit, Cup (Incls: 133,139,143,153)	1
301	—	30023 FPM	Kit, Cup (Incls: 133,139,143)	1
302	30841 FPM	—	Kit, Bac-Cup (Incls: 133,139,143)	1
	30240 NBR	—	Kit, Piston (Incls: 119,133,135-139,143,153)	1
	—	30210 NBR	Kit, Piston (Incls: 119,130,133,135-139,143)	1
305	30842 FPM	—	Kit, Bac-Cup Piston (Incls: 119,133,135-139,143,153)	1
	30312 NBR	30312 NBR	Kit, Sleeve & Prrrrm-A-Lube Seal (Incls: 75,77,80,106,139)	1
	30230 NBR	30230 NBR	Kit, Sleeve & Blue-Dot Seal (Incls: 75,77,80,101,106,139)	1
306	30305 NBR	30305 NBR	Kit, Prrrrm-A-Lube Seal (Incls: 106,139)	1
	30229 NBR	30229 NBR	Kit, Blue-Dot Seal (Incls: 101,106,139)	1
310	30686 S	30686 S	Kit, Valve - Q.V. (Incls: 143,164,166,167,168)	1
	30024 S	30024 S	Kit, Valve - F.V. (Incls: 143,164,166,167,168)	1

● Industrial discount. **Bold print part numbers are unique to a particular pump model.** *Italics are optional items.*

See Tech Bulletins 16, 17, 20, 24, 25, 26, 30, 34, 36, 37, 38, 43, 74 and 77 for additional information.

MATERIAL CODES (Not Part of Part Number): AL=Aluminum BB=Brass BBCP=Brass/Chrome Plated FCM=Forged Chrome-moly
 FPM=Fluorocarbon (Viton®) NBR=Medium Nitrile (Buna-N) POP=Polypropylene PTFE=Polytetrafluoroethylene (Teflon®) S=304SS SCP=304SS/Chrome Plated
 SS=316SS STCP=Steel/Chrome Plated STL=Steel STZP=Steel/Zinc Plated SZZ=304SS/Zamak ZZ=Zamak

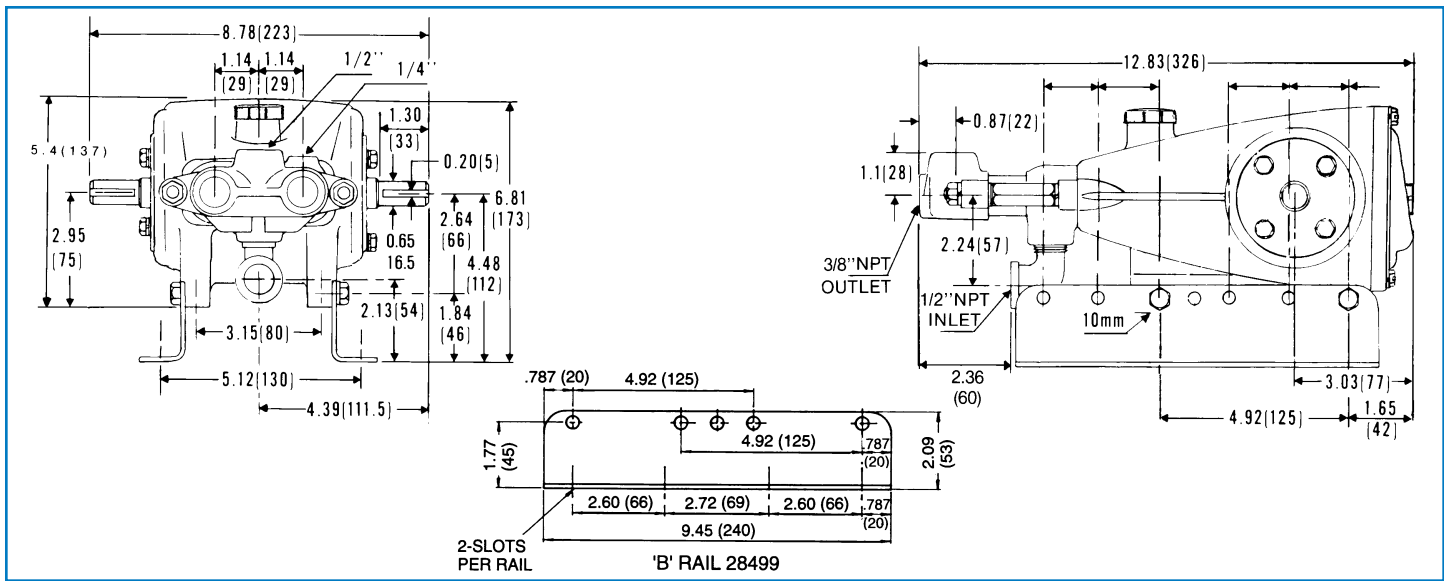

Models 333, 430

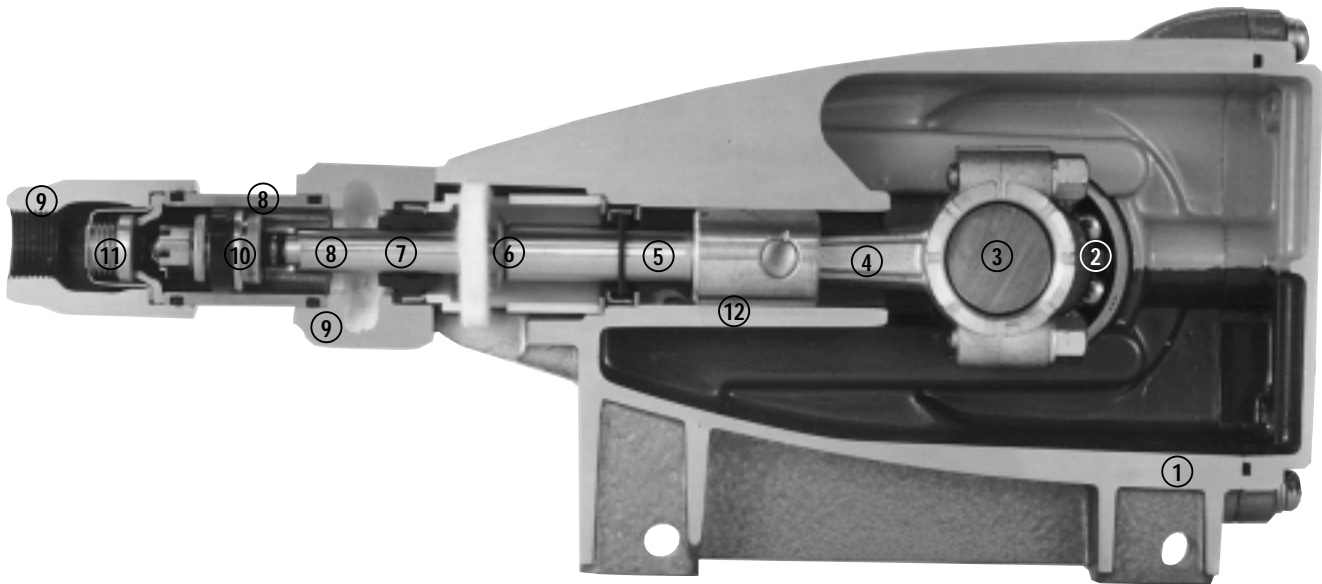

- 1 Die cast aluminum **crankcase** means high strength, lightweight, and excellent tolerance control.
- 2 Oversized crankshaft **bearings** provide extended bearing life and pump performance.
- 3 Chrome-moly **crankshaft** provides unmatched strength and surface hardness for long life.
- 4 Matched oversized **connecting rods** are made of Zamak, a material noted for strength and superior bearing quality.
- 5 The **piston rods** are high tensile strength 304 stainless steel with zamak crossheads.
- 6 The stainless steel **slinger** provides back-up protection for the crankcase seal, keeping pumped fluids out of the crankcase.
- 7 The **patented stepped piston rod** with hard chrome-plated stainless steel **sleeve** provides a durable wear surface and easy wet-end servicing.
- 8 The **cylinder and sleeve wear surfaces** are hard chrome-plated 304 stainless steel for longer service life.
- 9 **Manifolds** are of high tensile strength chrome-plated brass or 316 stainless steel for special corrosion resistance.
- 10 100% wet **cup/seal** design adds to service life by allowing pumped fluids to cool and lubricate the elastomers on both sides.
- 11 304 stainless steel **valves, seats, and springs** provide corrosion-resistance, positive seating and long life.
- 12 **Crossheads** are 360° supported for uncompromising alignment.

Products described hereon are covered by one or more of the following U.S. patents 3558244, 3652188, 3809508, 3920356, 3930756 and 5035580

Aug 1998 8819

World Headquarters

CAT PUMPS

1681 - 94th Lane N.E. Minneapolis, MN 55449-4324

Phone (612) 780-5440 — FAX (612) 780-2958

e-mail: sales@catpumps.com

www.catpumps.com

International Inquiries

FAX (612) 785-4443

e-mail: intlsales@catpumps.com



The Pump with "Nine Lives"

CAT PUMPS (U.K.) LTD.

1 Fleet Business Park, Sandy Lane, Church Crookham, Fleet

Hampshire GU13 0BF, England

Phone Fleet 44 1252-622031 — Fax 44 1252-626655

N.V. CAT PUMPS INTERNATIONAL S.A.

Heiveldekens 6A, 2550 Kontich, Belgium

Phone 32-3-450.71.50 — Fax 32-3-450.71.51

e-mail: cpi@catpumps.be

CAT PUMPS DEUTSCHLAND GmbH

Buchwiese 2, D-65510 Idstein, Germany

Phone 49 6126-93030 — Fax 49 6126-930333

e-mail: catpumps@t-online.de