



High Pressure Relief Valve

Model

7190

FEATURES

- Provides system pressure setting and protection for single or multiple gun and pump systems.
- Lightweight, compact design quickly and conveniently mounts directly into discharge line.
- Provides back-up protection to assure complete pressure relief for maximum pump and system protection.

SELECTION: Select a Relief Valve to meet or exceed the flow and pressure requirements of the system.

INSTALLATION: The Relief Valve should be mounted in the discharge line **before any other accessories in the system** to provide optimum

SPECIFICATIONS

	U.S. Measure	Metric Measure
Maximum Flow	6.5 GPM	(25 L/M)
Maximum Pressure	*5000 PSI	(345 BAR)
Maximum Temperature	194°F	(90°C)
Inlet Port	3/8" BSPF	(3/8" BSPF)
Discharge Port.....	3/8" BSPF	(3/8" BSPF)
By-Pass Port.....	3/8" BSPF	(3/8" BSPF)
Weight	16.7 oz.	(.47 Kg)
Dimensions	5.1 x 2.1 x 1.1"	(129.5 x 53 x 28 mm)

*Intermittent duty up to 5600 PSI (390 BAR).

protection to the pump. The by-pass from the Relief Valve may be returned to the reservoir or drain to the floor. By-pass returned to the inlet of the pump should be done with caution to avoid pressure spikes or excessive heat build-up from recirculating fluids.

continued on back

“Customer confidence is our greatest asset”

EXPLODED VIEW

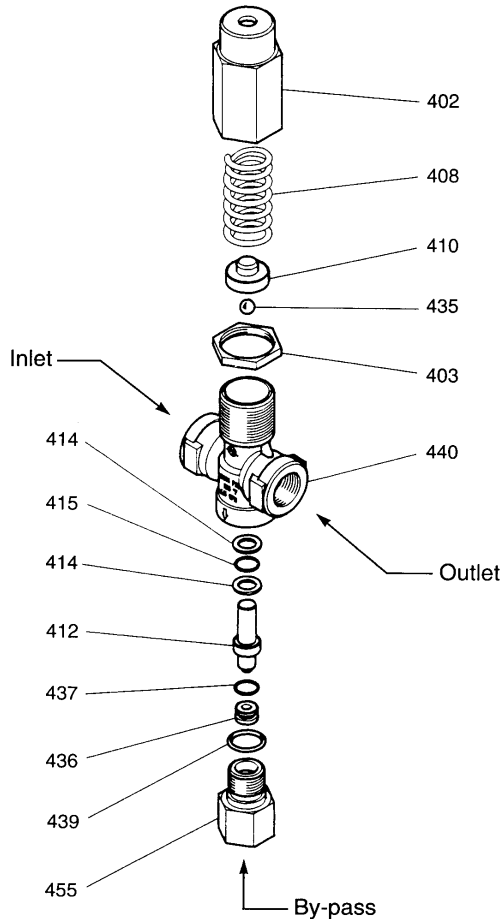

PARTS LIST

ITEM	P/N	MATL	DESCRIPTION	QTY
402	33404	BB	Cap, Hex Adjusting	1
403	33327	BB	Nut, Locking	1
408	33329	STZP	Spring	1
410	33408	BB	Guide, Spring	1
412	33409	S	Piston	1
414	33322	PTFE	Back-up-Ring	2
415	33363	NBR	O-Ring	1
435	33328	S	Ball	1
436	33383	S	Seat	1
437	33559	FPM	O-Ring	1
439	33378	FPM	O-Ring	1
440	—	BB	Valve Body	1
455	33405	BB	Fitting, By-pass	1
—	33435		Kit, O-Ring (Incls: 414, 415, 437, 439)	1

Italics are optional items.

Material Codes (Not Part of Part No.): BB=Brass FPM=Fluorocarbon (Viton®)
 NBR=Medium NBR PTFE=Polytetrafluoroethylene (Teflon®)
 S=304SS STZP=Steel/Zinc Plated

OPERATION: The hex adjustment cap is located at the top of the Relief Valve, the inlet and discharge ports are located on the sides and the by-pass port is located at the bottom. Using a 27mm wrench, the pressure setting may be **increased** by turning **clockwise** or **decreased** by turning **counterclockwise**.

The Relief Valve should be set in **small** increments. Check your pressure gauge following each adjustment. It may be convenient to **set your unloader or regulating device** for the system working pressure in **small** increments, as you are setting the Relief Valve. The final adjustment for the Relief Valve should be set to relieve at approximately **200 PSI above the system working pressure**.

REMEMBER, THE RELIEF VALVE IS A SECONDARY SAFETY DEVICE. IT DOES NOT REPLACE A PRESSURE REGULATOR OR UNLOADER.

TROUBLESHOOTING

Valve chatters	• Valve is improperly set. Repeat adjustment procedure.
Valve continually by-passes	• Seat or piston valve is worn. Replace as needed.
Leaking out the top of valve	• O-Ring on piston worn or cut. Replace as needed.

WARRANTY

90 Day Warranty

Refer to complete Cat Pump Warranty for further information.

Products described hereon are covered by one or more of the following U.S. patents 3558244, 3652188, 3809508, 3920356, 3930756 and 5035580

May 1999 4994

World Headquarters

CAT PUMPS

1681 - 94th Lane N.E. Minneapolis, MN 55449-4324

Phone (612) 780-5440 — FAX (612) 780-2958

e-mail: sales@catpumps.com

www.catpumps.com

International Inquiries

FAX (612) 785-4329

e-mail: intlsales@catpumps.com



The Pump with "Nine Lives"

CAT PUMPS (U.K.) LTD.

1 Fleet Business Park, Sandy Lane, Church Crookham, Fleet

Hampshire GU13 0BF, England

Phone Fleet 44 1252-622031 — Fax 44 1252-626655

N.V. CAT PUMPS INTERNATIONAL S.A.

Heiveldkens 6A, 2550 Kontich, Belgium

Phone 32-3-450.71.50 — Fax 32-3-450.71.51

e-mail: cpi@catpumps.be

CAT PUMPS DEUTSCHLAND GmbH

Buchwiese 2, D-65510 Idstein, Germany

Phone 49 6126-93030 — Fax 49 6126-930333

e-mail: catpumps@t-online.de www.catpumps.de